

Thomas : Stevenson

# For Sale

## LAND WITH RESIDENTIAL PLANNING CONSENT WELLINGTON STREET, STOCKTON-ON-TEES



### Location

The property is situated on the north side of Wellington Street, close to the junction with Prince Regent Street, approximately half a mile to the due west of Stockton High Street.

### Description

The site comprises a roughly square site on the site of the former Unitarian Church with full planning permission for the erection of 6 flats with associated car parking.

Planning consent has been given to application 07/0095/FUL granted on the 19 March 2007.

### Accommodation

The site extends to an area of approximately 225 sq m (269 sq yards)

### Proposed Terms

The site is offered for sale with the benefit of the existing planning consent at £125,000 freehold.

### VAT

All rentals/prices are exclusive of VAT.

### Viewing

The site may be viewed from the road and the site is marked by the Thomas : Stevenson for sale board.

Details of the full planning consent are available from Stockton Borough Councils online planning service.

For further information please contact:

Andrew Benzies/Lindsay Pearson

Email: [andrew@thomas-stevenson.co.uk](mailto:andrew@thomas-stevenson.co.uk)

Email: [Lindsay@thomas-stevenson.co.uk](mailto:Lindsay@thomas-stevenson.co.uk)

### Subject to contract

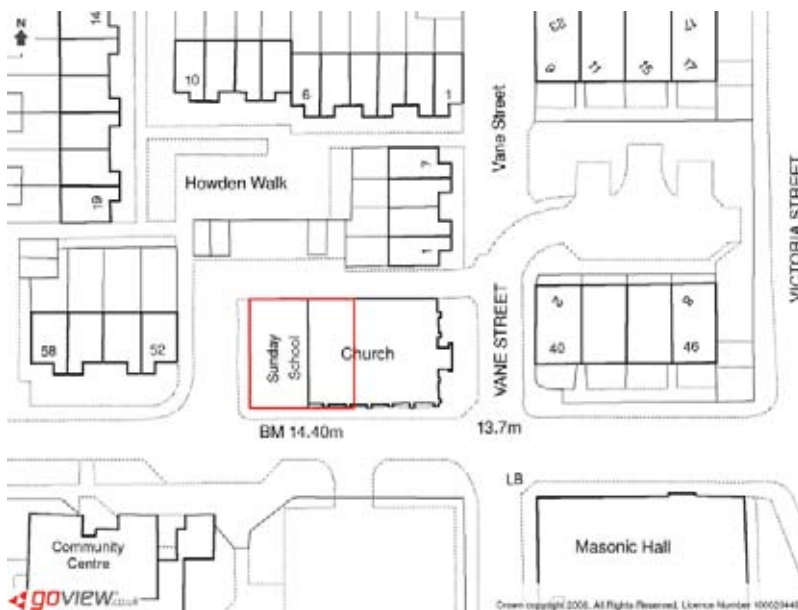

MISREPRESENTATION ACT 1967 Thomas Stevenson for themselves and for the vendors/lessors of any property for whom they act, give notice that:

- (i) These particulars are a general outline only, for the guidance of prospective purchasers or tenants, and do not constitute the whole or any part of an offer or contract;
- (ii) Thomas Stevenson cannot guarantee the accuracy of any description, dimensions, references to condition, necessary permissions for use and occupation and other details contained herein and prospective purchasers or tenants must not rely on them as statements of fact or representation and must satisfy themselves as to their accuracy;
- (iii) No employee of Thomas Stevenson has any authority to make or give any representation or warranty or enter into any contract whatsoever in relation to the authority;
- (iv) Prices/rents quoted in these particulars may be subject to VAT in addition; and
- (v) Thomas Stevenson will not be liable, in negligence or otherwise, for any loss arising from the use of these particulars.

IN A RAPIDLY CHANGING MARKET, THE PROPERTIES WITHIN THIS REGISTER MAY NOW BE UNDER OFFER, CONTRACTED, OR WITHDRAWN AND ACCORDINGLY YOU ARE REQUESTED TO CHECK THE STATUS OF ANY PROPERTY WHICH IS OF INTEREST WITH THOMAS STEVENSON. ALL DIMENSIONS AND AREAS ARE APPROXIMATE ALL PROPERTIES ARE OFFERED SUBJECT TO CONTRACT

