

Thomas : Stevenson

For Sale

39 BISHOPTON LANE, STOCKTON-ON-TEES



Location

The premises are located in a prominent secondary location within Stockton town centre. Nearby occupiers include Ramsden's Pawn Brokers, a Funeral Directors and a Double Glazing/Conservatory Centre. The property has the benefit of being situated directly in front of the Wellington Square public car park. The property benefits from significant passing vehicular traffic, being situated at the junction of Bishopton Lane and Leeds Street.

Description

The premises comprise of a mid-terrace 3 storey building offering ground floor sales accommodation with upper floor offices and stores.

The premises could be suitable for a variety of occupiers and uses subject to the necessary planning consents.

Accommodation

Ground Floor	
Retail:	119.81 sq m (1,289 sq ft)
First Floor	
Offices / Stores:	106.0 sq m (1,141 sq ft)
Second Floor	
Stores:	37.89 sq m (408 sq ft)

Tenure

The premises are offered for sale Freehold. Offers are invited based on £150,000.

Business Rates

Interested parties should contact the Local Authority for the business rates payable.

Legal Costs

Each party is to be responsible for their own legal costs in connection with this transaction.

VAT

All prices are exclusive of VAT.

Viewing

Strictly by appointment through sole agents office
Tel: 01642 713303

Subject to Contract

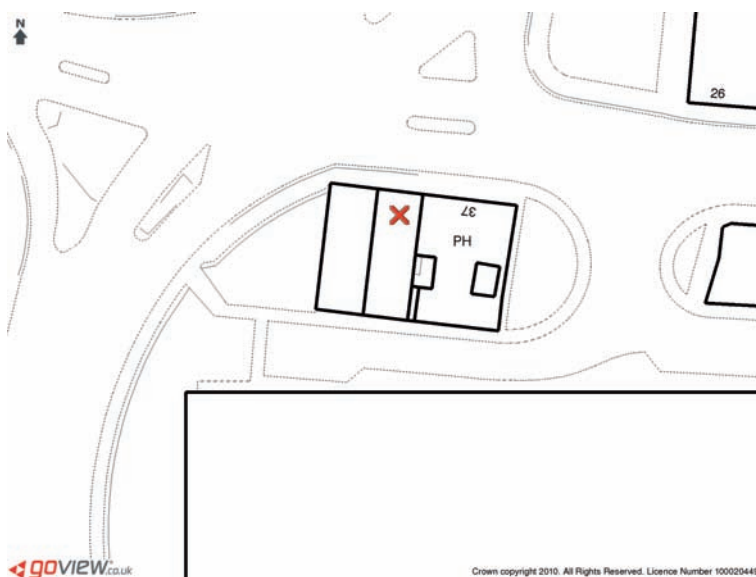
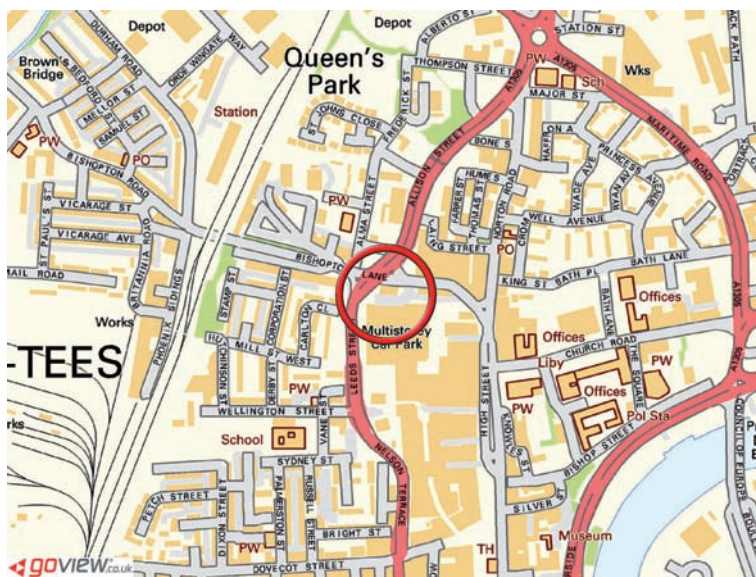
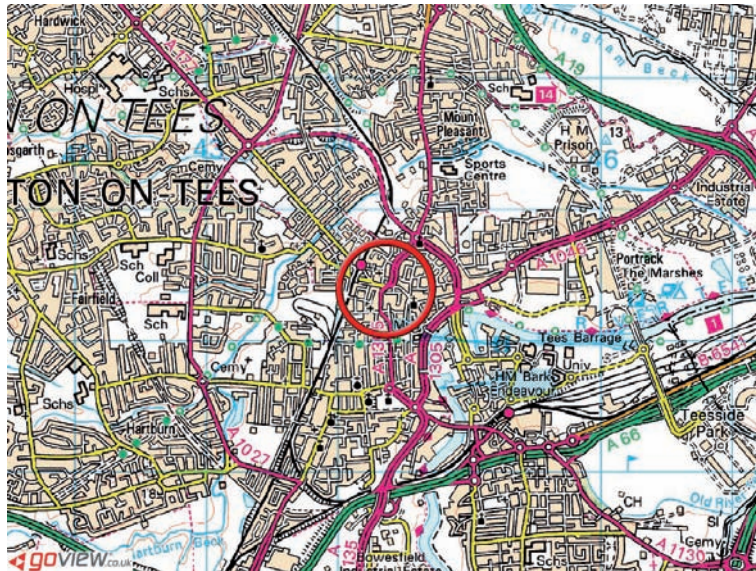

MISREPRESENTATION ACT 1967 Thomas Stevenson for themselves and for the vendors/lessors of any property for whom they act, give notice that:

- (i) These particulars are a general outline only, for the guidance of prospective purchasers or tenants, and do not constitute the whole or any part of an offer or contract;
- (ii) Thomas Stevenson cannot guarantee the accuracy of any description, dimensions, references to condition, necessary permissions for use and occupation and other details contained herein and prospective purchasers or tenants must not rely on them as statements of fact or representation and must satisfy themselves as to their accuracy;
- (iii) No employee of Thomas Stevenson has any authority to make or give any representation or warranty or enter into any contract whatsoever in relation to the authority;
- (iv) Prices/rents quoted in these particulars may be subject to VAT in addition; and
- (v) Thomas Stevenson will not be liable, in negligence or otherwise, for any loss arising from the use of these particulars.

IN A RAPIDLY CHANGING MARKET, THE PROPERTIES WITHIN THIS REGISTER MAY NOW BE UNDER OFFER, CONTRACTED, OR WITHDRAWN AND ACCORDINGLY YOU ARE REQUESTED TO CHECK THE STATUS OF ANY PROPERTY WHICH IS OF INTEREST WITH Thomas Stevenson. ALL DIMENSIONS AND AREAS ARE APPROXIMATE ALL PROPERTIES ARE OFFERED SUBJECT TO CONTRACT

